

DA1206D600R-10

UNCONTROLLED DOCUMENT

PHYSICAL DIMENSIONS:

A	3.20 [.126]	+ 0.20 [.008]
B	1.60 [.063]	+ 0.20 [.008]
C	0.80 [.031]	+ 0.20 [.008]
D	0.40 [.016]	+ 0.15 [.006]
D1	0.30 [.012]	+ 0.200 [.008]
E	0.80 [.031]	+ 0.10 [.004]

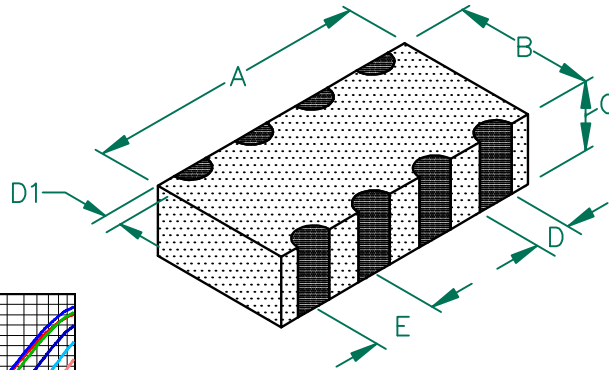

ELECTRICAL CHARACTERISTICS:		
Z @ 100MHz (Ω)	DCR (Ω)	Rated Current
Nominal	60	
Minimum	45	
Maximum	75	400 mA
LINE TO LINE INSULATION RESISTANCE >100 M Ω AT 75 VOLTS.		

NOTES: UNLESS OTHERWISE SPECIFIED

1. TAPED AND REELED per CURRENT EIA SPECIFICATIONS 7" REELS, 3000 PCS/REEL.
2. TERMINATION FINISH IS 100% TIN.
3. COMPONENTS SHOULD BE ADEQUATELY PREHEATED BEFORE SOLDERING.

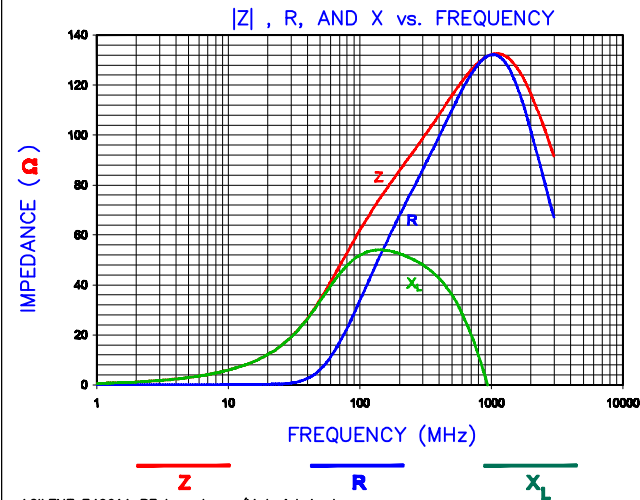
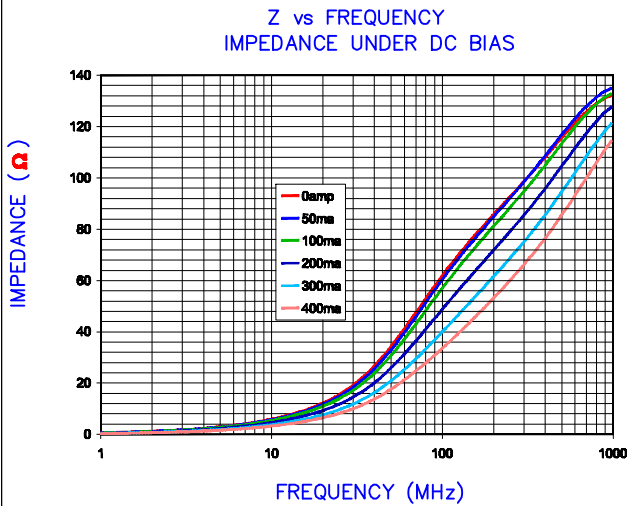

AGILENT E4991A RF Impedance/Material Analyzer
HP 16194A Test Fixture. TEST REF. 3236



LAND PATTERNS FOR REFLOW SOLDERING

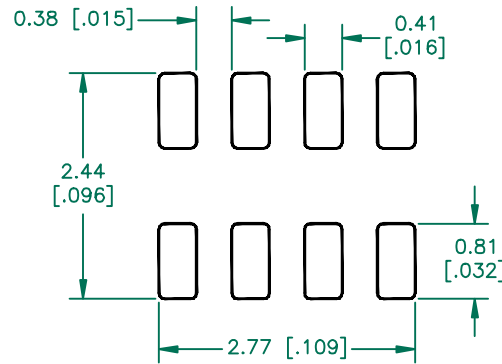

(For wave soldering, add 0.762 (0.030) to this dimension)

RECOMMENDED SOLDERING CONDITIONS

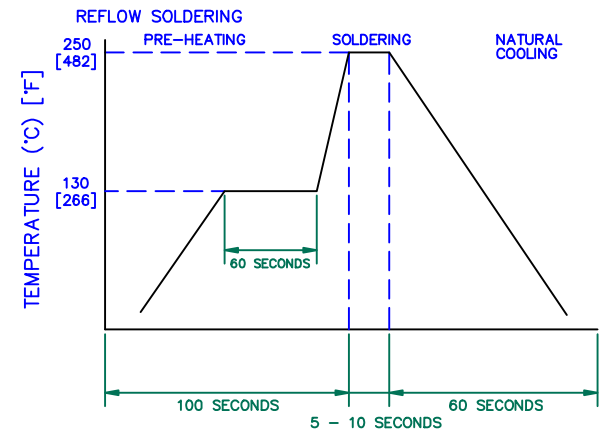

DIMENSIONS ARE IN mm [INCHES].				THIS DOCUMENT CONTAINS INFORMATION WHICH IS PROPRIETARY AND CONFIDENTIAL TO STEWARD. NO PRODUCTION OR PUBLICATION OF THIS DOCUMENT IN WHOLE OR IN PART SHALL BE MADE WITHOUT WRITTEN AUTHORIZATION FROM STEWARD.			
				Steward		Laird	
PROJECT/PART NUMBER:				REV	PART TYPE:	DRAWN BY:	
C D1 dim chgd from 0.008 ±0.004 to 0.012 ± 0.008. UPDATE COMPANY LOGO 10/31/07 JRK				DA1206D600R-10	C	CO-FIRE	TMB
B	ADD ROHS COMPLIANT SYMBOL	08/20/04	TMB	DATE:	04/02/04	SCALE:	NTS
A	ORIGINAL DRAFT	04/02/04	TMB	CAD #	DA1206D600R-10-C	TOOL #	-
REV	DESCRIPTION	DATE	INT	SHEET: 2 of 2			